

APPLIED DESIGN

2024



MAREINER



MAREINER	04
ALPINE WALL PANELS	20
DESIGN PANELS	28
FLOORING	34
TERRACE & POOL	44
FAÇADE	54
SAUNA & SPA	68
DOORS	74
FURNITURE	84
ARCHITECTURE SERVICE	92



MAREINER



WOOD IN ALL ITS FORMS OF EXPRESSION.

100 % NATURE.
100 % MAREINER.

This says where we come from: From Sankt Marein in Styria,
where we have since branched out to Schlierbach in Upper Austria and
Považská Bystrica in the Slovakian Fatra region.

And this also says what we do: 100% natural wood design.

We consciously move on the surface, even if its value is often underestimated.

But what do you really see when you look at a façade, a floor,
a wall, a ceiling, a piece of furniture?

Exactly: the surface. And we design this exclusively out of pure wood.

Each piece is unique: This is how we make boards, components and design panels
for inside and outside. For houses and halls, chalets, saunas, terraces, as well as
furniture and building construction. With our knowledge of the art of wood
finishing acquired over many years of researching, learning and perfecting.

And with nothing more than fire, water, natural glazes and oils and,
above all, reputable metal tools.

We stand by the words of a writer who strikes our conviction like a hammerhead
hits a nail: "The true mystery of the world is the visible, not the invisible."

The depth of a surface is part of this mystery: grain, tone, feel, smell.

And the fact that the name of our wordsmith, Oscar Wilde,
inevitably reminds us of the primitive and wild, which is all the better:

Because we are and work with 100% nature.





360°
LIVING SPACE
DESIGN



**IN SANKT MAREIN WE REFINE
FRESHLY SAWN WOOD INTO
BEAUTIFUL BOARDS. ACCORDING
TO ALL THE RULES OF ART.**



SANKT MAREIN

OUR ENERGY CENTER IN THE MÜRZTAL VALLEY

It all began in Sankt Marein in the Mürztal Valley in green Styria. Because we started to rock an old sawmill, transforming it into a house for the artistic finishing of fresh wood with planers, flames, hatchets, steam and the like. Out of sheer joy in doing the work and the zest for trying something new.



POVAŽSKÁ BYSTRICA

OUR DESIGN PANEL
FACTORY IN THE SLOVAKIAN
FATRA REGION

In terms of landscape, the wooded and gently undulating Fatra region in northeast Slovakia looks quite similar to that in the Krems and Mürz valleys. Absolutely identical, however, is the Mareiner spirit in which we produce our elegant and generously-sized design panels in our brand spanking new pressing plant in Považská Bystrica – known as Waagbistritz in German.

**POVAŽSKÁ BYSTRICA IS
THE BIRTHPLACE OF OUR
THREE-LAYER DESIGN PAN-
ELS. PRESSED UNDER THE
HIGHEST PRESSURE FROM
THE FINEST WOOD.**

**AT MAREINER ALTHOLZ IN
SCHLIERBACH, WE HELP GIVE
VINTAGE WOOD A SECOND LIFE.
WITH LOVE AND RESPECT.**

SCHLIERBACH

OUR RECLAIMED WOOD
MASTERS IN THE KREMSTAL
VALLEY

Not many can do what we can: deal with sunburnt, wind and weather-tanned reclaimed wood patinated by the long passage of time the way we do at Mareiner Altholz. Our workshops and halls are located on the Krems River below the famous Schlierbach Abbey. Here we prepare panels and floorboards from repurposed roof trusses and barns with all their peculiarities for a brilliant second life.



THE SUITABLE ONE FROM THE MAREINER COLLECTION

ALPINE WALL PANELS & DESIGN PANELS

GRAN PARADISO 190°
GRAN PARADISO 212°
MONT BLANC 212°
GROSSGLOCKNER
ZUGSPITZE
MONTE ROSA
MATTERHORN
MARMOLADA
PIZ BERNINA
PIZ BUIN
PIZ NAIR
PIZ LAGREV
PIZ PALÜ
JUNGFRAU
EIGER

	WALL & CEILING	FLOORING	TERRACE & POOL	FAÇADE	SAUNA	SPA	DOORS	FURNITURE	TABLE
GRAN PARADISO 190°	●				●	●	●	●	●
GRAN PARADISO 212°	●			●	●	●	●	●	●
MONT BLANC 212°	●			●	●	●	●	●	●
GROSSGLOCKNER	●			●	●	●	●	●	●
ZUGSPITZE	●					●	●	●	●
MONTE ROSA	●					●	●	●	●
MATTERHORN	●				●	●	●	●	●
MARMOLADA	●				●	●	●	●	●
PIZ BERNINA	●			●		●	●	●	●
PIZ BUIN	●			●		●	●	●	●
PIZ NAIR	●			●	●	●	●	●	●
PIZ LAGREV	●			●	●	●	●	●	●
PIZ PALÜ	●				●	●	●	●	●
JUNGFRAU	●	●		●		●	●	●	●
EIGER	●	●				●	●	●	●

ORIGINAL RECLAIMED WOOD

ZERMATT
WENGEN
GSTAAD
CRANS MONTANA
LENZERHEIDE
ADELBODEN
SANKT MORITZ
DAVOS

ZERMATT	●			●	●	●	●		●
WENGEN	●			●	●	●	●		●
GSTAAD	●			●	●	●	●	●	●
CRANS MONTANA	●			●	●	●	●	●	●
LENZERHEIDE	●			●		●	●		●
ADELBODEN	●			●		●	●		●
SANKT MORITZ	●			●		●	●	●	●
DAVOS	●			●		●	●	●	●

BLACK EDITION

VULCANO BLACK

PIZ BERNINA BLACK

WÖRTHERSEE BLACK

GRAN PARADISO BLACK

GRAN PARADISO BLACK

	WALL & CEILING	FLOORING	TERRACE & POOL	FAÇADE	SAUNA	SPA	DOORS	FURNITURE	TABLE
VULCANO BLACK	●			●					
PIZ BERNINA BLACK	●			●			●	●	●
WÖRTHERSEE BLACK	●			●			●	●	●
GRAN PARADISO BLACK	●			●			●	●	●
GRAN PARADISO BLACK	●			●			●	●	●

FLOORING

SIMPLON

FURKAPASS

ST. BERNARD

STELVIO

GALIBIER

SELLAJOCH

SIMPLON		●							
FURKAPASS		●							
ST. BERNARD		●							
STELVIO		●							
GALIBIER		●							
SELLAJOCH		●							

TERRACE

KEBONY

GARDASEE

WÖRTHERSEE

PLATTENSEE

KEBONY	●		●	●		●		●	
GARDASEE	●		●	●		●		●	
WÖRTHERSEE	●		●	●		●			
PLATTENSEE			●						

MODIFICATIONS

We are absolutely convinced that it has what it weighs. However, you don't have to put everything on the scales. Strictly speaking, all wood finishing is a modification. A modification is nothing more than a consciously made change. Nevertheless, in wood design we make a distinction between modification and finishing. For us, modifications are the three major basic processes that take priority over any other or further finishing: thermal treatment, steaming and Kebonization.

THERMAL TREATMENT

Credit where credit is due: The thermal treatment process was developed by the Technical Research Centre of Finland. When wood is subjected to this process, it gains dimensional stability and durability. Its color becomes elegantly darker. This is an industrial process for heat treating wood. The thermal treatment process can be divided into three phases.

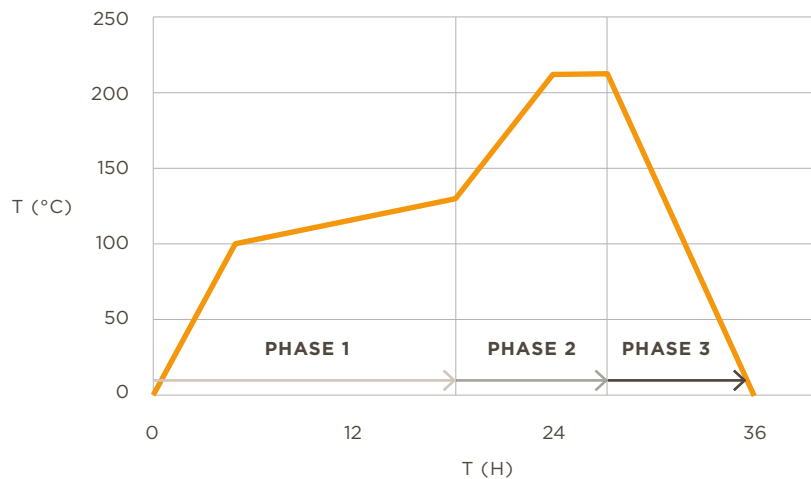

T (°C) ... Thermal Treatment (Temperature)
T (H) ... Thermal Treatment (Time)

PHASE 1: TEMPERATURE INCREASE AND HIGH-TEMPERATURE DRYING

- Using heat and steam, the oven temperature is quickly raised to around 100 °C.
- The temperature is then steadily increased to 130 °C – the high temperature at which the wood dries.
- The moisture content of the wood drops to almost zero.

PHASE 2: INTENSIVE HEAT TREATMENT

- Once high-temperature drying has taken place, the temperature inside the oven is increased to a level between 185 and 230 °C.
- Once the planned temperature level is reached, it is kept constant for two to three hours, depending on the intended use.

PHASE 3: COOLING AND MOISTURE CONDITIONING

- In the final step, the oven temperature is reduced to 80 to 90 °C using water spray systems. If the oven thermometer shows this value, humidification is carried out again to bring the wood moisture content to around 4-7%.

ADVANTAGES

Wood gains dimensional stability and durability.

The color becomes elegantly darker and the positive effect highlights the natural contrast of the wood grain.



STEAM TREATING

- The modification of steam treating is similar to a stay in the sauna that lasts for three weeks. The wood lies in a steam chamber around the clock in a room at 90 °C.
- The long-term treatment does not fail to have its effect: It gives the wood a very special color that cannot be achieved with any other means.

ADVANTAGE

After the steaming process, the wood, which has been treated for many days, presents itself in an elegant brown color hue, which subtly contributes to a pleasant spatial experience.

KEBONIZATION

As the ® in Kebony® clearly indicates, this is a patented processing method. As with thermal treatment, its roots reach to Scandinavia (not Finland, but Norway). In an environmentally friendly way, it improves the properties of softwood from sustainably managed forests so that it permanently takes on the qualities of hard tropical wood. Kebonization involves a permanent change in the cell structure of the wood, which also changes color and becomes dark brown.

STEP 1: IMPREGNATION

At the beginning of the treatment, the wood is given a full bath in furfuryl alcohol. It remains there until every cell is soaked in the high-proof liquid.

STEP 2: CURING AND DRYING

- After impregnation, the wood is dried under heat.
- During this hardening process, the wood becomes dimensionally stable: The furfuryl alcohol has a polymerizing effect.

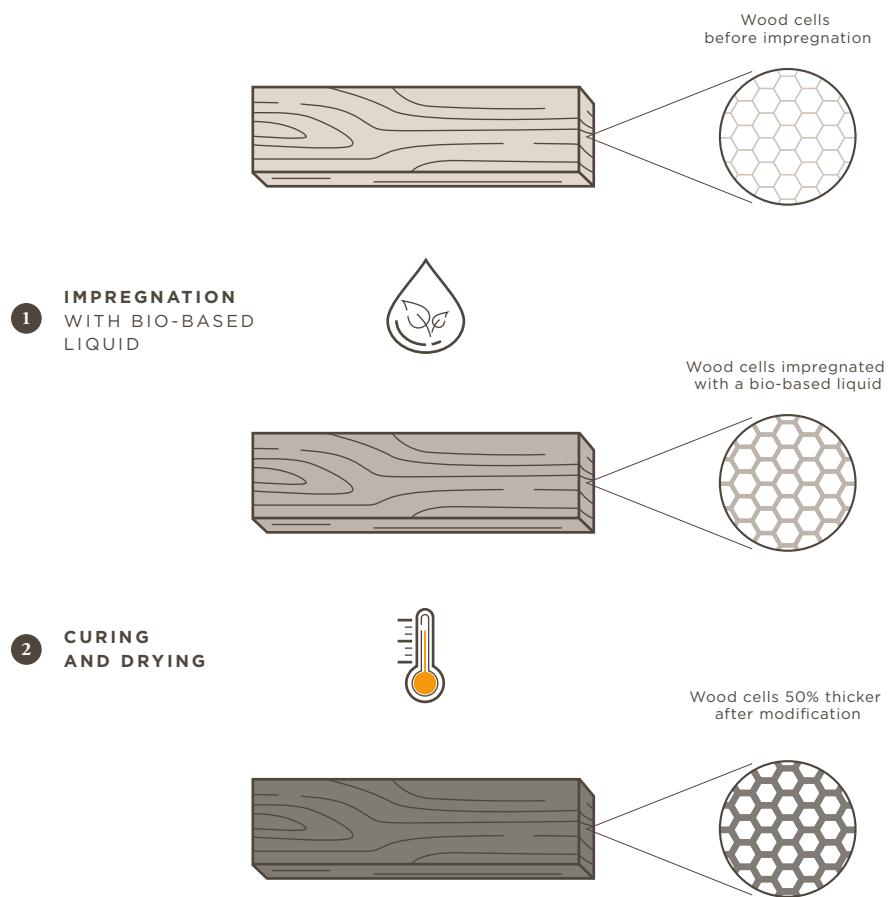

STEP 3: RESULT

- After treatment, the wood cells are approximately 50% thicker thanks to the stable, anchored polymers.
- The permanent modification of the wood cell walls ensures the excellent stability of the wood, the maximum hardness, as well as a guaranteed long lifespan.
- Kebony – i.e. Kebonized wood – also offers a high level of safety, as the wood hardly splinters and contains neither toxins nor synthetic chemicals.

ADVANTAGES

- Whether heat, frost or constant rain: Kebony® remains dimensionally stable.
 - Kebony® lasts for decades, even under extreme weather conditions.
 - Due to the bone-hard surface, it is almost impossible for Kebony® to become splintered: Welcome to the best barefoot floor!
-

FROM OUR REPERTOIRE

Wood finishing is as fascinating as wood itself: Each finishing process changes the original character of the raw surface and highlights one of its facets – and accentuates it at the same time.

PROFILING

PLANING

So that it no longer remains rough around the edges, we teach our wood manners. With two precision planing machines that ensure flawlessly smooth surfaces, the right shape and a characteristic profile.



DOUBLE-ENDED PROFILING

Like so many people, our boards also strive to show themselves from the best profile. Unlike some of our contemporaries, they are not concerned with respect and admiration. It's rather a matter of simple and easy installation with minimal waste.

SURFACE DESIGN

BRUSHING

As the iron-bristled brushes go over the wood, it's time for the softer parts within to say goodbye. The harder wood components remain. This makes the board more resistant overall – for example, against the weather. In addition, the characterful grain becomes more prominent.



SANDING

When it comes to boards, a polished appearance also includes a flawless complexion. This is created when we very finely roughen the previously carefully planed wood with fine-grain sanding brushes to open it up for the caring effect of oils and glazes. Or to improve stain and color adhesion.



HACKING

Hacked wood reminds us of the early history of carpenters without machines, who felled timber with their axes. With an expressive result that we achieve today with the help of a machine developed in-house over several years, which turns every piece of hacked wood into a unique item.

BANDSAW CUTTING

As with any job, good tools are also a prerequisite for success here: The razor-sharp teeth of the saw band roughen the wood surface with regular and fine cuts so that oils and glazes can penetrate deeper into the wood and create an attractive look.



FRAME SAW CUTTING

Our frame saw cut allows wood to visually return to the place where it was first processed: The sawmill, where the rise and fall of the frame saw teeth leave a characteristic cutting pattern with its own charm.

EMBOSSING

No finishing process shapes character more deeply than wood embossing: It is the pinnacle of individual surface design. Bringing the desired pattern into the wood using pressure and heat so that it harmonizes with the wood's natural design requires skill and sensitivity.



BURNING & CHARRING

Transforming wood and making it even more durable by burning the surface in a controlled manner is an ancient cultural technique. Under the impact of the flames, the wood reveals its inner structure, which becomes all the more apparent as the subsequent brushing removes the soft early wood, exposing the hard late wood.

ORIGINAL RECLAIMED WOOD

ORIGINAL RECLAIMED WOOD

Freshly arrived, reclaimed wood is first cleaned using a high-pressure cleaner with pure water. Then we begin the sorting process. Every board, every beam and every rafter goes through an individual check and categorization. After professional sorting, which requires years of experience and a keen eye, we cut the precious historical raw materials and let them dry in peace. We then brush, plane or sand the venerable material and release it in a new splendor into its second life – in which it delivers a brilliant performance as a character actor in tailor-made living spaces.



COATING

OILING & COATING

Wood grayed by wind and weather is beautiful. But wood is also beautiful if, thanks to a biological coating, it retains its original appearance for a long time – or changes color right away. The careful application of ecologically sound decking oils and glazes is also reflected in greater resistance.



MICROPLANING

The special microplaning technique creates countless tiny depressions in the wood surface and roughens the wood very finely so that it absorbs significantly more pigments when glazing or staining.

ASSEMBLY & FINISHING

GLUING & PRESSING

Producing laminated panels is precision work: First of all, the slats for the top and back layers need to be cut precisely, then the glue needs to be applied absolutely evenly to the middle layer before everything is heated and pressed together.





MILLING & DRILLING

Poor acoustics are the death sentence for guest, seminar and meeting rooms. You can avoid this with professionally milled and drilled acoustic elements, which do not reflect the sound excessively, but rather lure it quasi onto a backstage.

CARPENTRY

We also know how to make something beautiful out of our reclaimed wood and design panels, as well as particularly fine pieces of vintage wood: table and worktops, door blanks and furniture galore.



TYROLEAN CASTLE

What at first makes you think of a powerful, fortified fortress in the mountains is a special feature with tradition: The ready-to-assemble corner edge made of tongue and groove boards, beautiful to look at, easy to assemble and reassuringly stable. To do this, we glue pieces of end grain wood to the block wall and mill out the dovetail joint. We can build your Tyrolean Castle in all local types of wood: depending on the wood, in widths of 160-200 mm and lengths between 4 and 5 m.

THIS COMES WITH THE TERRITORY

PRECISE DELIVERY DOWN TO THE PIECE

While we concentrate on the best possible quality, we also have an awareness of quantity. This means that we produce and deliver exactly the quantity you need down to the piece. As a matter of principle, we do not take part in the game of fluctuation ranges or fixed batch sizes which is popular elsewhere.



PACKAGING & STORAGE

Admittedly, this is not a special finishing technique. But that is what matters if you want the wood to get to you in the form and with the surfaces we have given it for you.

SAMPLE EXPRESS

We know it: A picture says a thousand words. But they don't necessarily have to tell the whole story. After all, an object always looks a little different in reality than in a photo. To be able to understand the special features, sensuality and charisma of the diverse Mareiner range, we provide an extensive Mareiner sample service.

To make sure our customers have something in their hands and can get a personal impression of the different and distinct Mareiner woods, we are happy to send 30 x 20 cm product samples throughout Europe.

Good to know: Wood is lively and each piece is one-of-a-kind. The personal samples can – and most likely will – vary slightly in structure and color from what you will later receive in larger quantities when you order. To put it in another way, these delightful little differences lie in the nature of nature.

THIS IS HOW FAST IT GOES:

- 1 Find what you like online at mareiner.com.
- 2 Place your selection in the sample case and
- 3 complete your order. We produce each sample individually and according to your individual wishes.



THE MAREINER PRODUCT IN DIGITAL FORM

For visualizations and specific planning for customer consultations, we are happy to provide detailed product photos digitally and in high-resolution. These can be viewed in advance on the website and be requested directly from the Mareiner marketing department at any time.



**COPY & PASTE: TENDER TEXTS
FOR ARCHITECTS & PLANNERS**

We will be careful not to interfere in the work of architects and planners, but we would like to make it easier: with ready-made tender texts, which we are happy to make available digitally. You can order them from your Mareiner contact person or at office@mareiner.com



YOUR ORDER, OUR SAMPLE MAN: MARIO WINTER; IN WINTER, SOME WISHES END UP WITH SANTA CLAUS. IN OUR CASE, YOUR DESIRE FOR A SAMPLE LANDS IN THE MAREINER JOINERY WITH OUR SAMPLE MAN: MARIO WINTER, WHO IS RESPONSIBLE FOR OUR SAMPLE BOARDS AND HAND SAMPLES. AND, YOU GUESSED IT, WORKS IN AN EXACT, EXEMPLARY WAY.



PRIVATE HOUSE BREGENZERWALD
FROM MAREINER: PIZ BUIN
PHOTOGRAPHY: MARCEL HAGEN STUDIO22.AT

ALPINE WALL PANELS



ALPINE WALL PANELS

You can do whatever you want with Mareiner wall panels – and create exactly the atmosphere you have in mind in every room. The four-sided profiling gives you the security of quick assembly with minimal waste. (This profiling is not technically possible with the Piz Lagrev panel type and all original reclaimed wood products because the wood does not allow it.)



EVERYTHING YOU NEED TO KNOW IS ON THE PRODUCT SHEET

The detailed product sheet for the panel can be downloaded from the media library at mareiner.com.

It provides you with detailed information about all production steps, properties, dimensions and special features.



ALL PROFILES AT A GLANCE

C00

MINI BEVEL: 1.5 mm
 LENGTH OF TONGUE: 8 mm
 WITHOUT RELIEF CUTS
 (FOR THERMALLY TREATED PRODUCTS)

CR

RHOMBUS STRIP LOOK
 CLOSED PROFILE,
 ESPECIALLY SUITABLE FOR FACADES

C01 (STANDARD PROFILE)

MINI BEVEL: 1.5 mm
 LENGTH OF TONGUE: 8 mm
 WITH RELIEF CUTS

SPLINE JOINT (VULCANO)

BEVEL: 3 mm
 LENGTH OF GROOVE: 10 mm

C010

MINI BEVEL: 1.5 mm
 LENGTH OF TONGUE: 10 mm

SHADOW GAP 3 / 5 / 8 MM

MINI BEVEL: 1.5 mm
 SHADOW GAP: 3, 5 or 8 mm

C02

MINI BEVEL: 1.5 mm
 LENGTH OF TONGUE: 15 mm

SOFTLINE

ROUNDED EDGES
 SHADOW GROOVE: 10 mm

C03

BEVEL: 3 mm
 LENGTH OF TONGUE: 8 mm



ALM WELLNESS HOTEL PIERER, AUSTRIA
CLIENTS: PIERER FAMILY
ARCHITECTURE: JOSEF GÖBEL GMBH
FROM MAREINER: ZUGSPITZE
PHOTOGRAPHY: HARALD EISENBERGER

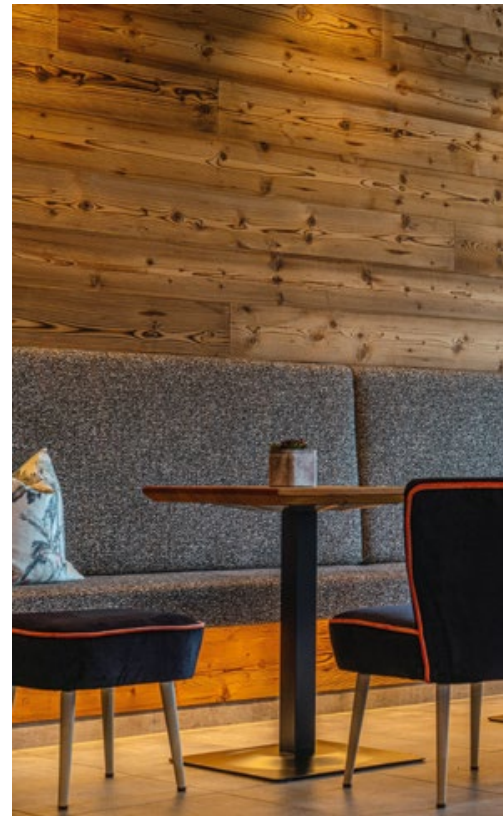



PRIVATE HOUSE H., AUSTRIA
INTERIOR DESIGN: STEFAN SCHWEIGHOFER
FROM MAREINER: PIZ BUIN
PHOTOGRAPHY: MARCEL HAGEN, STUDIO22.AT



BOUTIQUE HOTEL STADTVILLA SCHLADMING, AUSTRIA
ARCHITECTURE: INNENARCHITEKTUR STRANGER
PLANNING & IMPLEMENTATION: SCHWAB-WALCHER GMBH
FROM MAREINER: MARMOLADA LAVA
PHOTOGRAPHY: CHRISTINE HÖFLEHNER



IN THE ALPINE SUN: THE WALL PANEL IN THE CHALET

A large part of the wood entrusted to us for finishing comes from the Alps. We honor this origin by designing a whole range of wall panels with an alpine character. And we are pleased that some of them are returning to the Alps: to the façades and cozy rooms of sophisticatedly designed chalets. Since wind and weather in the mountains are harsher than elsewhere, we are happy to equip our panels with the appropriate protection, especially for outdoor use. Our sales team will be happy to advise you individually.



CHALET F., LAPLAND, FINNLAND
ARCHITECTURE: FINNCOLLECTION
FROM MAREINER: GRAN PARADISO 190°
PHOTOGRAPHY: ROMAIN FAVELIER



CHALETS SCHLADMING, AUSTRIA
ARCHITECTURE: GMP ARCHITEKTUR ZT KG
CARPENTRY WORK: CHRISTIAN GRUBER
FROM MAREINER: MARMOLADA VECCHIA,
PIZ NAIR, PIZ BERNINA
PHOTOGRAPHY: TONI MUHR



AADLA WALSER CHALETS, AUSTRIA
CLIENTS: SCHWARZMANN FAMILY
FROM MAREINER: PIZ BERNINA LAVA, MARMOLADA
PHOTOGRAPHY: DOLORES RUPA FOTOGRAFIE



PRIVATE HOUSE G., AUSTRIA
FROM MAREINER: PIZ BERNINA LAVA
PHOTOGRAPHY: TONI MUHR



DESIGN PANELS



DESIGN PANELS

With our design panels, you have a material that is strong and beautiful, as well as extremely variable, and displays its advantages especially in furniture and commercial construction. You can choose from a wide range that provides you with many different finished wooden surfaces. The top and bottom layers of our design panels are visually identical to the panels of the same name. Carefully and skillfully processed, they feature a spruce or larch core.

TECHNICAL FEATURES

MAIN FORMAT	LENGTH	3.96 or 4.96 m (depending on the product), resp., 1.5 to 4.0 m for reclaimed wood panels
	WIDTH	1220 or 2000 mm
TOP LAYER		<ul style="list-style-type: none">• Possible for all Mareiner products*• Seamless gluing• Visual appearance depending on the desired product
MIDDLE LAYER		<ul style="list-style-type: none">• For all spruce top layers, the middle layer is made of spruce.• For all larch top layers, the middle layer is made of larch.• If desired, any middle layer can be manufactured with the top layer wood type.
BOTTOM LAYER		<ul style="list-style-type: none">• Same type of wood as in the top layer• As a non-visible version, closed & sanded• On request, the bottom layer can be made in the same quality or look of the top layer.
GLUING		<ul style="list-style-type: none">• Melamine-urea system• Dispersion adhesive D4
STANDARD		<ul style="list-style-type: none">• E1, formaldehyde value according to ÖNORM EN 13986• Formaldehyde content \leq 0.01 ppm

* except Piz Lagrev & Vulcano

TO ENHANCE AND COMPLETE YOUR PANEL'S APPEARANCE

If requested, we can pack the appropriate edge banding for your design panels. In solid wood design, 3 mm thick.

ⓘ TROPICAL CONDITIONS

A Mareiner panel transforms every sauna into a design object. And every façade outside, too. To make sure you can enjoy it for years to come, we have to provide our design panels with special gluing or frost-proof gluing for outdoor use to protect them from steam, heat, wind and weather. Please contact us if you are planning a sauna or façade with Mareiner design panels.

THIS IS WHAT YOU SHOULD KNOW

- Three-layer solid wood panels are made of solid wood.
- Swelling and shrinkage behavior must be taken into account.
- If the ambient humidity is too high, the wood will absorb moisture and this will lead to dimensional changes and warping.
- If the ambient humidity is too dry, warping or fine surface cracks may occasionally occur. These are natural properties of wood and not manufacturing defects.

THE STRUCTURE OF YOUR DESIGN PANEL



**A ROBUST MIDDLE LAYER LIES BETWEEN THE TOP AND BOTTOM LAYERS
IN THE DESIGN PANEL.**



GEIER. DIE BACKEREI GMBH, AUSTRIA
ARCHITECTURE: LADENBAU AICHINGER
FROM MAREINER: DAVOS, ZERMATT
PHOTOGRAPHY: MICHAELA BEGSTEIGER, KRUMBÖCK GMBH

PRIVATE HOUSE G., AUSTRIA
CLIENTS: GLOGER FAMILY
ARCHITECTURE:
HOLZARCHITEKTEN ZT KG
FROM MAREINER: PIZ BERNINA LAVA
PHOTOGRAPHY: TONI MUHR





PRIVATE HOUSE H., VORARLBERG, AUSTRIA
INTERIOR DESIGN: STEFAN SCHWEIGHOFER
FROM MAREINER: PIZ BUIN
PHOTOGRAPHY: MARCEL HAGEN, STUDIO22.AT



HOTEL BERGHOF,
RIESNERALM, AUSTRIA
FROM MAREINER: GRAN PARADISO
PHOTOGRAPHY: KATARINA
PASHKOVSKAYA





PRIVATE HOUSE PANORAMA
FROM MAREINER: SIMPLON
PHOTOGRAPHY: MAXIMILIAN HAIDACHER

FLOORING

We are happy if you like Mareiner – and like to stand on their products. Very happy, if you take it literally. And through your choice of floorboards, we ensure that we will lie at your feet forever.

THE TOP FEATURES OF OUR FLOORING



tongue / groove



easy-care



chamfered



suitable
for underfloor
heating

We recommend a glue-down installation of the floorboards.

THE CLASSICS

THE MAREINER OAK COLLECTION

PRODUCT	WOOD TYPE	FINISH (STANDARD)	ADDITIONAL FINISHES
SIMPLON	Oak, natural	brushed	naturally oiled
		brushed	raw effect
		brushed	white-oiled 16 %
		brushed	stained gray-shaded
		brushed	white-oiled 2 %
		brushed	flamed oiled
FURKAPASS	Oak, smoked	brushed	oiled
		brushed	white-shaded
ST. BERNARD	Oak, core-smoked	brushed	oiled

FURTHER FINISHING OPTIONS

- brushed relief
- bandsaw cut
- hand-finished
- 3D structure
- hacked
- reclaimed Alpine wood

QUALITIES



SELECT

The SELECT floorboards are among the most serene contemporaries: They are visually calm and - except for one or two point knots - largely knot-free. Differences in color within and between the boards are inherent.

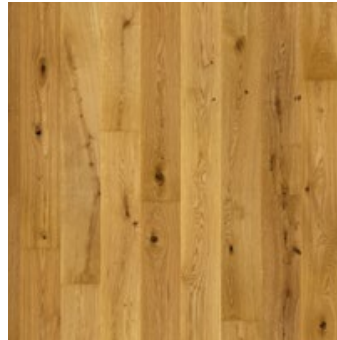

NATURELL

Life pulsates on the surfaces of these floorboards: Knots in an unlimited number and size provide visual variety and a lively dynamic. Possibly right in the middle of it: Neatly filled cracks in the knots and carefully filled loose knots.

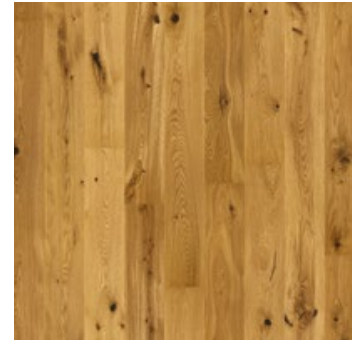

RUSTIQUE

This floor enables you to bring a piece of wilderness into your home: The wild child among our floorboards is self-confident and proud of its peculiarities. Like the pristine and rustic look with knots and loose knots - carefully filled of course - without any size or quantity limits. Also with a small amount of sapwood.

WHAT SETS THE CLASSICS APART

- Hand-picked European oak
- 4-mm wear layer for multiple renovations – 6- and 8-mm wear layers also upon customer request
- Middle layer made of slow-growing spruce – to reduce swelling and shrinkage with vertical growth rings
- Cross gluing for high stability and suitability for underfloor heating
- Balancing layer: European spruce
- Tongue and groove profile with 4-sided microbevel
- Standard surface brushed and oiled with Rubio Monocoat Natural

FORMATS

STANDARD FORMATS

Wear layer: approx. 4 mm

ALL DIMENSIONS IN MM

THICKNESS	15						
LENGTHS*	1800 - 2400					2800 - 3000	
WIDTHS	80	120	160	190	250	300	300
RUSTIQUE	x	x	x	x	x	x	x
NATURELL	x	x	x	x	x	x	x
SELECT	x	x	x	x	x	x	x

Wear layer: approx. 5-6 mm

ALL DIMENSIONS IN MM

THICKNESS	16			
LENGTHS*	3000 - 5000 (Depending on the raw materials, a proportion of 20% may be included in lengths of 3000 - 4000 mm.)			
WIDTHS	160/190	250	300	350
RUSTIQUE	x	x	x	x
NATURELL	x	x	x	x
SELECT	x	x	x	x

EXCLUSIVE FORMATS

Wear layer: approx. 5-6 mm

ALL DIMENSIONS IN MM

THICKNESS	17.5	
LENGTHS*	3000 - 6400 (up to 12000 mm on request) (lengths depending on raw material options)	
WIDTHS RANDOM	200 - 400	300 - 500
RUSTIQUE	x	x
NATURELL	x	x
SELECT	x	x

* random, fixed lengths upon request

Additional exclusive formats:

- Lengths up to 12 meters and room-length dimensions on request
- 8-mm wear layer possible for an additional charge
- Max. 4 widths in a fair distribution
- Depending on the width of more than 300 mm, not every hand-made surface can be produced.
- Please note the additional charge for packaging in wooden boxes – for safe transport.

THE SPECIAL ONES

THE MAREINER OAK SPECIAL COLLECTION

PRODUCT	TYPE OF WOOD	FINISH
STELVIO ORIGINAL	Oak, steam-treated, original surface	brushed
STELVIO	Oak, steam-treated, middle layer	brushed
GALIBIER ORIGINAL	Reclaimed oak, original surface	brushed
GALIBIER	Reclaimed oak, middle layer	brushed
SELLAJOCH ORIGINAL	Reclaimed spruce/fir/pine, original surface	brushed
SELLAJOCH	Reclaimed spruce/fir/pine, middle layer	brushed

WHAT SETS THE SPECIAL ONES APART

- Finishes in steamed oak or original reclaimed wood
- Standard three-layer structure
- Sellajoch and Sellajoch Original finishes also as solid wood floorboards possible (not suitable for underfloor heating)
- Cross gluing for high stability and suitability for underfloor heating
- Middle layer made from local natural spruce – edge-glued to reduce swelling and shrinkage
- Balancing layer made of local natural spruce with continuous slats
- Tongue and groove profile with 4-sided mini-bevel
- Surface brushed or sanded and oiled as desired

ON THE PERFECT FLOOR OF FACTS

CLIMATE AND CHANGE

- Wood is hygroscopic: It has the ability to bind moisture.
- Depending on the amount of moisture absorbed, it either swells or shrinks.
- The ambient temperature also affects the dimensions.
- Choosing the right room temperature and humidity will protect your floor from damage.
- Therefore, keep the ambient temperature between 15 and 30 °C.
- The surface temperature of the floor must not exceed 29 °C.
- Maintain a relative humidity between 30 and 65 %.
- This not only creates ideal climatic conditions for your floorboards, but also for your health and well-being.

IN COLOR

- So-called extraction substances give wood its natural color. Under the influence of light, they change both themselves and the color of the wood.
- How strong these color changes – also known as oxidation – are depends on the type of wood. During this natural process, previously hidden lines or minerals naturally occurring in the wood can become visible.
- Oak is generally color stable, but over time tends to warmer tones and an intensification of its golden yellow color. This change also occurs on colored oiled or smoked oak floorboards. Smoked flooring tends to lighten slowly.
- If wood is exposed to direct sunlight, e.g., exposed intensively and over a very long period of time by large glass surfaces, it can lose its color.
- UV-protective foils on the glass surfaces or curtains protect your floors from excessively intense sunlight.

THE CARE OF JOY

- If you give your floor some attention from time to time in the form of care, you will enjoy its natural elegance for longer.
- Clean it no more than once a week and treat it to high-quality but sparingly used care and cleaning products. On floors that are cleaned too often or with too high a dosage, a thin layer of soap sometimes remains on the surface on which dust and dirt settle.
- Ideally you use two buckets. One for the water and wood soap mixture, the other for clean water to clean the mop.
- It is sufficient to wipe the surface with a damp cloth and not walk on the floor until it is completely dry. A more intensive effect of water on the surface is counterproductive.

FOR MACHINE CLEANING AND CARE OF COMMERCIAL FLOORING

Mareiner floors are oiled so that they can easily be cleaned mechanically and provided with maintenance oil. Before using the machine for the first time, please check with the manufacturer whether the device can actually handle parquet floors. We would also be happy to advise you personally at any time. If you wish, we will gladly send you our cleaning and care instructions for commercial floors.

MAREINER OFFICE, STYRIA, AUSTRIA

CLIENT: MAREINER HOLZ GMBH

ARCHITECTURE: MARION WICHER, WOW ARCHITECTEKTUR

FROM MAREINER: SIMPLON

PHOTOGRAPHY: TONI MUHR

FLOORING





PRIVATE HOUSE PANORAMA, STYRIA, AUSTRIA
ARCHITECTURE: MARION WICHER, WOW ARCHITECTURE
FROM MAREINER: SIMPLON, CRANS MONTANA, WÖRTHERSEE
PHOTOGRAPHY: MAXIMILIAN HAIDACHER



PRIVATE HOUSE W, AUSTRIA
FROM MAREINER: GARDASEE
PHOTOGRAPHY: TONI MUHR



TERRACE & POOL

TERRACE & POOL

A second home in the warm season, a house beach by the pool, a fresh air salon or a private grill restaurant: The terrace is a stage of life that plays all the pieces – and the longer and better, the higher the quality of the materials and the more careful the execution are.

ALL TERRACE PROFILES AT A GLANCE

SMOOTH EDGE BEVELED 2 MM



SENOFIX KEBONY



SMOOTH EDGE ROUNDED 2 MM



SENOFIX GARDASEE
19 / 20 / 21 / 25 / 27 MM

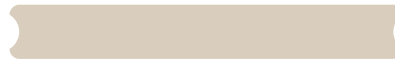

ON RECOMMENDATION OF THE HOUSE

CONSTRUCTIVE AND FUNCTIONAL

- Since terraces are inevitably constantly exposed to the effects of the weather, they need special protection. A fundamental part of this protection is ensured by clever design (the other part consists of regular maintenance and care by humans).
- Avoid wood-to-wood contact surfaces: Capillary action creates permanent damp spots that sooner or later cause wood rot.
- Like a living room, a terrace also needs ventilation. By leaving enough distance from the surface, you ensure air circulation.
- Avoid having the substructure strips come into direct contact with the subsurface – even if it is not soil, but a gravel bed or concrete.

- Please ensure that the correct gaps width is formed between the boards, which depends on the board width and mounting system. Gaps that are too narrow prevent water and contamination from draining away. Rot formation can be the unpleasant result.
- This also applies to the longitudinal gap, which should also be executed at an appropriate spacing. Ideally, the longitudinal gaps do not lie directly on the substructure wood. This is the only way water and dirt can flow away or fall through.
- There needs to be at least 20 mm clearance from surrounding components. Strongly recommended for connection to walls, patio door frames and the like: the aluminum drainage profile from the Mareiner range.
- We recommend our aluminum ventilation element for front facing. This ensures controlled water drainage and ventilation of the decking on the underside, including the entire substructure.

ANOINTMENT: POURING OIL ON THE WOOD

When you oil your terrace, it is a beauty treatment and anti-aging treatment in one: You protect the wood from graying, increase its resistance and accentuate its natural grain. Good oil works its way into the interior of the floorboards without sealing the surface or leaving an oil film on it. It protects your terrace inside and out and supports the wood in absorbing and releasing rain, dew and condensation or water from the pool.

- The right moment for the first oiling is before assembly. Please read the manufacturer's instructions carefully. The correct application differs from oil to oil and from wood to wood.
- Some terrace oils and woods are designed for two oiling processes. Only apply terrace oil that is designated for outdoor use.
- The second oiling process should be completed a few weeks after installation.
- We would be happy to take care of the first anointment for you. Then your floorboards are already pre-sanded at the factory and oiled on all four sides. Remember that an industrial oil application, like the one we achieve with our coating system, lasts longer.
- If your terrace floorboards are planed smoothly, sand the surface with the appropriate grain size. When roughened, the floorboards can absorb the oil much more evenly and deeply.
- If you want to do something good for your terrace, oil it once a year.
- Borrow our terrace cleaning machine. Mechanical cleaning and care extends the hard outdoor life of your space.
- Check regularly whether all gaps and other water drains are open and free of dirt.



For further assembly, maintenance and care instructions for oiled terraces, please take a look at our terrace guide. You can find it in the media library at mareiner.com.



WEATHER AND WEATHER

- Even the best weather protection is only of limited help in the long term against the formation of cracks and splinters, which can never be completely ruled out even with dedicated care – wood is not concrete (and even concrete changes under the influence of the weather).
- How your terrace floorboards change due to the effects of extreme seasonal temperature fluctuations as well as sunlight and rain varies from wood to wood.
- In the case of terrace floorboards directly exposed to the weather, ingredients will soon start to be washed out of the wood. This can lead to discoloration of adjacent components.
- The Mareiner terrace guide also provides you with detailed information on weathering.

TROPICALLY TESTED

- The best choice for the longevity of your terrace is Kebony floorboards
(SEE PAGE 49, 50, 51, 53)
- To simplify and reiterate here, the modification of Kebonization, using only alcohol and heat, gives softwood the properties of hardwood.
- Kebony allows you to enjoy the qualities of tropical wood without having to clear the rainforest.
- These qualities are excellent stability, maximum hardness and the de facto exclusion of splintering.

PEDESTRIAN BRIDGE ROSENBERG
FROM MAREINER: KEBONY
PHOTOGRAPHY: KATHARINA
PASHKOVSKAYA

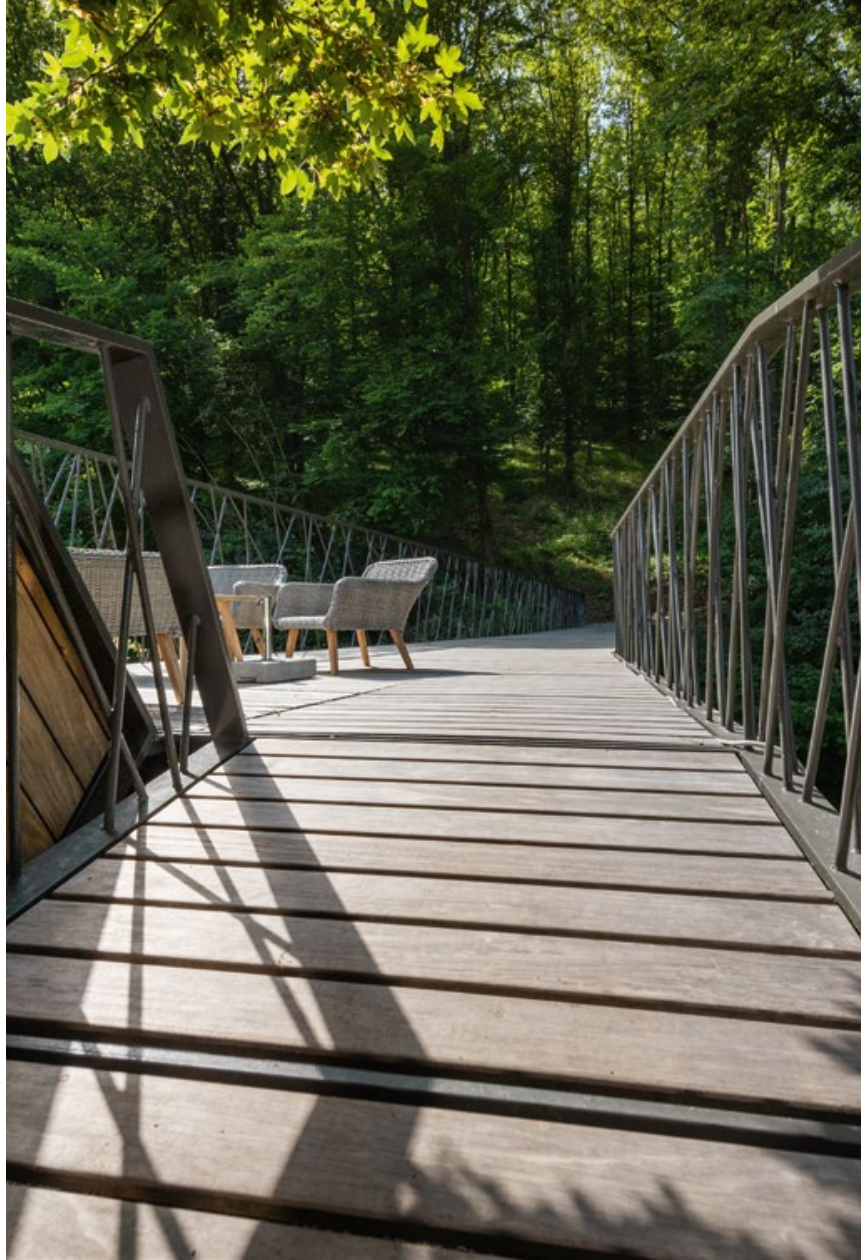

TERRACE
& POOL



PRIVATE HOUSE, GRAZ, AUSTRIA
FROM MAREINER: GARDASEE
PHOTOGRAPHY: JASMIN
SCHULLER





MOTTO AM FLUSS, VIENNA, AUSTRIA
CLIENT: BERND SCHLACHER
ARCHITECTURE: BEHF ARCHITECTS
FROM MAREINER: KEBONY
PHOTOGRAPHY: STEFAN DIESNER

**KINDERGARTEN OBERROHRBACH,
AUSTRIA**

CLIENT: MARKET TOWN OF
LEOBENDORF

ARCHITECTURE: AH3
ARCHITEKTEN ZT GMBH

FROM MAREINER: WÖRTHERSEE

PHOTOGRAPHY: MAM-ARTS



TERRACE
& POOL

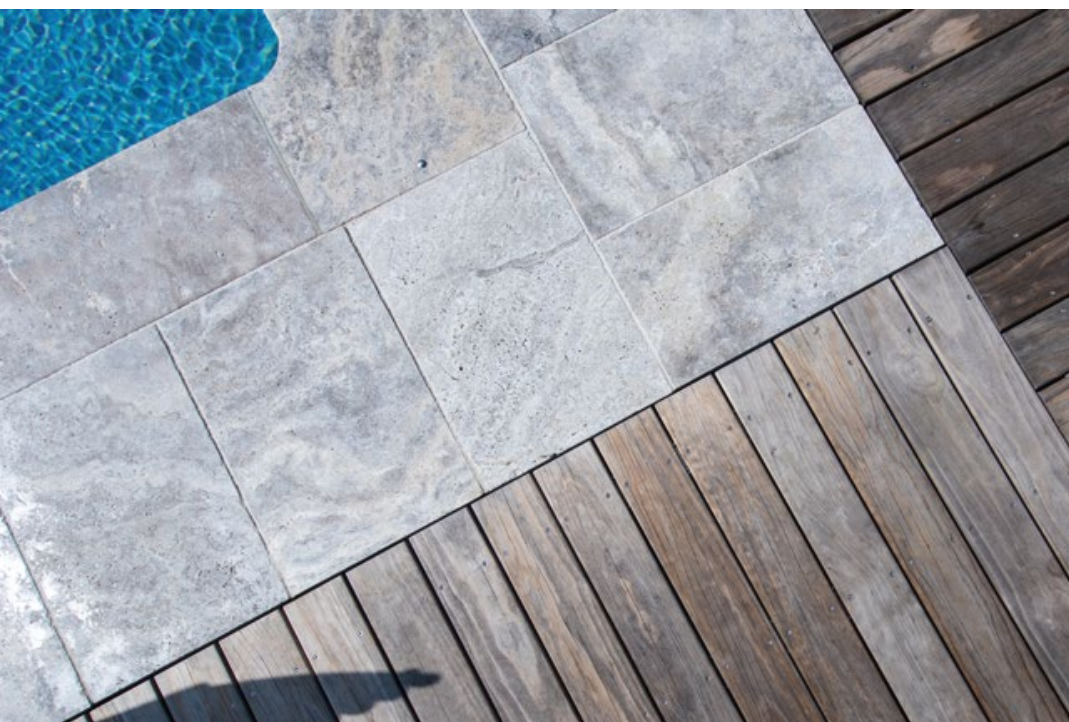

**PRIVATE HOUSE K.,
STYRIA, AUSTRIA**

PLANNING: MAREINER
ARCHITECTURAL ADVISOR
FRITZ SUPPAN

FROM MAREINER: KEBONY
PHOTOGRAPHY: KATARINA
PASHKOVSKAYA



PRIVATE HOUSE KARO, SALZBURG, AUSTRIA
CLIENTS: BLASCHKE FAMILY
ARCHITECTURE: RAUMBAU ARCHITEKTEN SALZBURG
FROM MAREINER: GARDASEE
PHOTOGRAPHY: HELGE KIRCHBERGER



PRIVATE HOUSE D., AUSTRIA
ARCHITECTURE: MARION WICHER, WOW ARCHITECTURE
FROM MAREINER: KEBONY
PHOTOGRAPHY: TONI MUHR

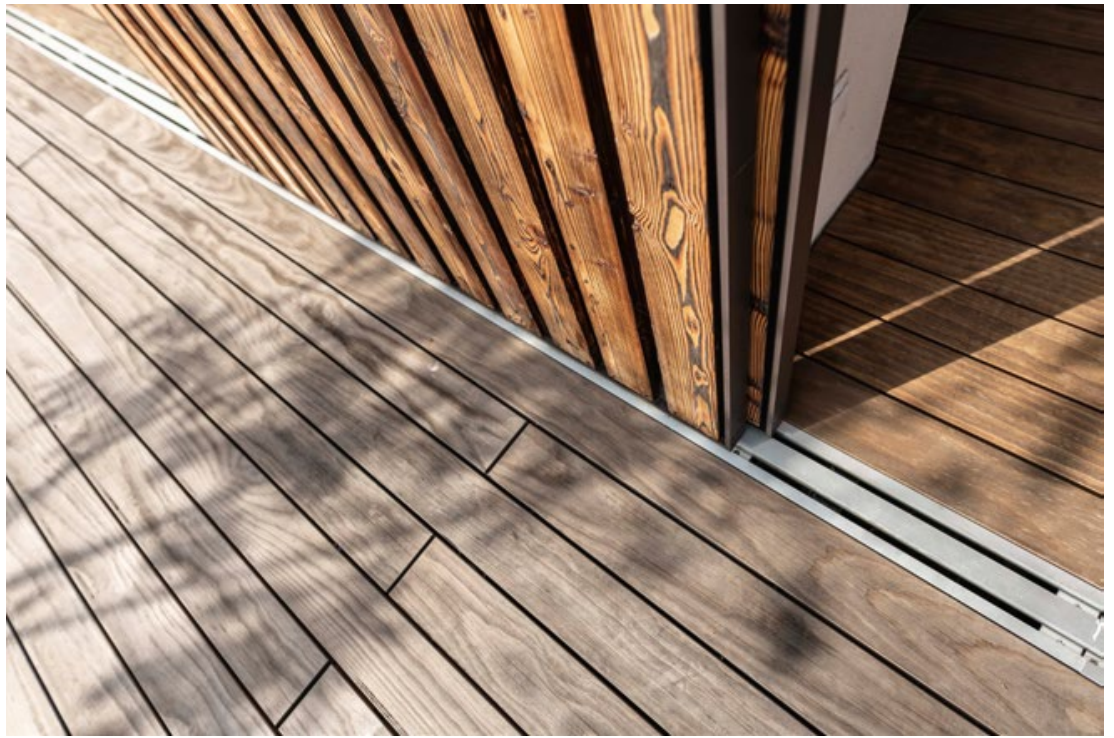

PRIVATE HOUSE G., AUSTRIA
CLIENTS: GLOGER FAMILY
ARCHITECTURE: HOLZARCHITEKTEN ZT KG
FROM MAREINER: PIZ BERNINA LAVA, KEBONY
PHOTOGRAPHY: TONI MUHR

TERRACE
& POOL





PRIVATE HOUSE BÄCK, AUSTRIA
FROM MAREINER: GRAN PARADISO 212°
PHOTOGRAPHY: KATARINA PASHKOVSKAYA

FAÇADE



FAÇADE

The fact that the true mystery of the world lies in what is visible particularly pertains to the façade. Its manifold purpose of existence is of a technical and aesthetic nature. It protects and conceals, but at the same time allows the owners and residents to express themselves through the façade and communicate to the world without words.

WE HAVE PROFILE



RHOMBUS 15° OR 30°



SMOOTH EDGE



GROOVE ON BOTH SIDES WITH A SPLINE JOINT



C 01



TONGUE AND GROOVE WITH SHADOW GAP 3 / 5 / 8 MM



DIFFERENT-SIZED WOOD WITH TONGUE AND GROOVE AND SHADOW GAP



DOUBLE RHOMBUS



RECLAIMED WOOD TONGUE AND GROOVE

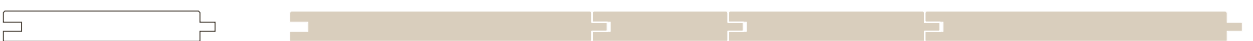

RECLAIMED WOOD GROOVE ON BOTH SIDES WITH A SPLINE JOINT



SURFACES

Our façade elements protect your structure from wind, weather, insects and confusion. Because we continually reinvent the façade – entirely according to the design task. To do this, we pull out all the finishing and packing stops and prepare the wood perfectly for your project and its location. So that your façade becomes a statement. Just like the façades we show you here. Just an example of what Mareiner façades can do. —————>

COATINGS

OIL-BASED COATING

An oil penetrates deep into the pores of the wood. This protects the wood from the inside from moisture. Nevertheless, the wood remains breathable and vapor-permeable, which means it can absorb moisture and release it again at a later time.

WATER-BASED COATING

Water-based coatings offer the advantages of quick drying and therefore faster usability. Due to the low odor development, they are also much more pleasant to process. And cleaning tools with water is easier. Another important advantage of water-based coating systems is their color stability and their optimal suitability for indoor use.

SOLVENT-BASED COATING

Solvent-based coating systems are particularly characterized by their excellent hiding and filling properties. A further advantage is their adhesion – solvent-based coatings offer more safety on a wide variety of surfaces. However, when it comes to durability, resilience and surface hardness, water-based coatings are now equivalent or even better than solvent-based coatings.

JUST A FEW EXAMPLES



HOTEL RESTAURANT KRAINER
Wörthersee
thermally treated
bandsaw cut
gray-coated

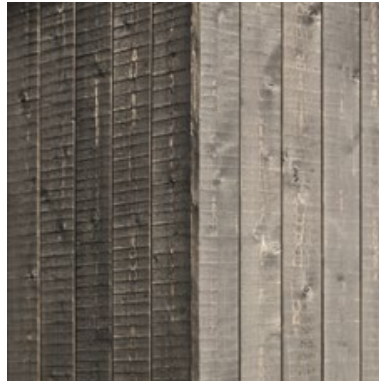

PRIVATE HOUSE KIRSCHHAUS
Gran Paradiso 212°
thermally treated
bandsaw cut
pre-grayed



**MULTI-PURPOSE HALL
ZISTERSDORF**
Gran Paradiso 212°
thermally treated
pre-grayed



**WALDSPA NATURE HOTEL
FISCHERWIRT**
Kebony
charred and coated



**PRIVATE HOUSE KARO,
BLASCHKE FAMILY**
Gardasee
thermally treated

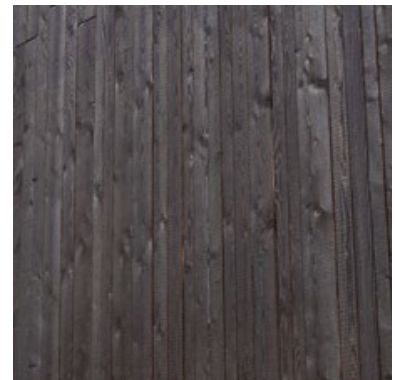

PRIVATE HOUSE GARS AM KAMP
Piz Bernina Black
natural
frame saw cut
black-coated



**PLANAI MOUNTAIN
CABLE CAR STATION**
Gran Paradiso 212°
thermally treated
pre-grayed and coated

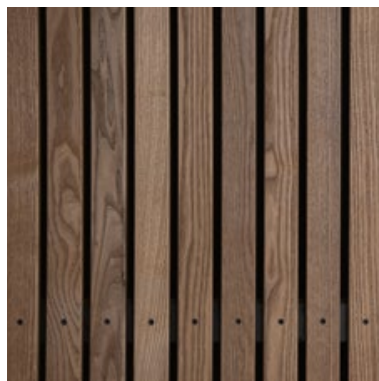

HOTEL RESTAURANT ZUM OXN
Gardasee
thermally treated

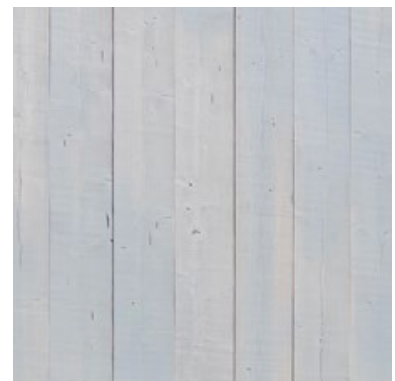

PRIVATE HOUSE PERNITZ
Gran Paradiso 212°
thermally treated
bandsaw cut
steel gray-coated



**THE ORCHESTRA FOR YOUR REQUEST PROGRAM:
OUR COATING PLANT**

“You wouldn’t treat yourself to anything else,” we said to ourselves when we dug deep into our pockets and gifted ourselves with high-performance coating machines that complement the machinery in our workshops and halls in Sankt Marein. They open up nearly endless possibilities for us and you to individually coat the panels for your façade. Life may not always be a request program, but coating at Mareiner is.

A STAR CAST

It's not just our know-how and it's not just our machines that make a façade coating from Sankt Marein a quality feature. Our partners and allies are just as important. These are exclusively well-known manufacturers and brands from the best houses. Like **Jotun**, **Adler** and **Rubio Monocoat**, with whom we work closely. And we can rely on their expertise at any time to always be able to offer you the optimal coating variant.

GRAY ON GRAY ON GRAY

If you want, we can do the work of wind and weather straight from the factory. And deliver your façade in a pre-grayed level of your choice. The five-part grayscale shows you what this can look like. Whereby we are far from finished when it comes to shades of gray: We can also do things differently. And, of course, provide you with the proper samples.

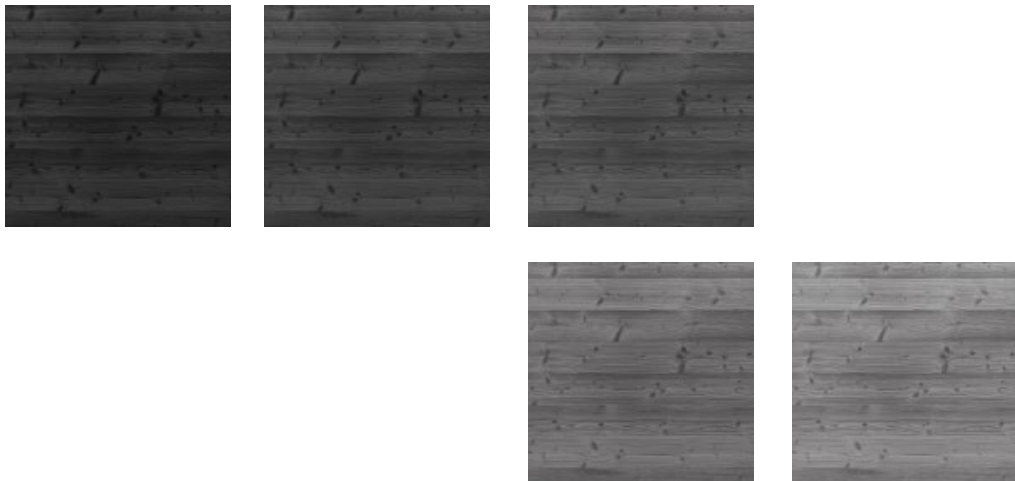



PRIVATE HOUSE G., AUSTRIA
ARCHITECTURE: HOLZARCHITEKTEN ZT KG
FROM MAREINER: PIZ BERNINA LAVA
PHOTOGRAPHY: TONI MUHR





WALDSPA NATURE HOTEL FISCHERWIRT, AUSTRIA
CLIENTS: RUDI AND MARIETTA EBNER
ARCHITECTURE: KIRCHMAYR PLANUNG GMBH
FROM MAREINER: KEBONY, CHARRED AND COATED
PHOTOGRAPHY: KATARINA PASHKOVSKAYA



PRIVATE HOUSE BÄCK, AUSTRIA
CLIENTS: MICHAEL AND SABRINA BÄCK
ARCHITECTURE: MICHAEL BÄCK
FROM MAREINER: GRAN PARADISO 212°,
 DARK COATED & WITH FINE BANDSAW CUT
PHOTOGRAPHY: KATARINA PASHKOVSKAYA





CHALETS SCHLADMING, AUSTRIA

ARCHITECTURE: GMP ARCHITEKTUR ZT KG

CARPENTRY WORK: CHRISTIAN GRUBER

FROM MAREINER: MARMOLADA VECCHIA, PIZ NAIR, PIZ BERNINA

PHOTOGRAPHY: TONI MUHR



PRIVATE HOUSE E., GERMANY
PLANNING & IMPLEMENTATION: LEBENSRAUM HOLZ GMBH
FROM MAREINER: ZERMATT
PHOTOGRAPHY: MICHAEL VOIT

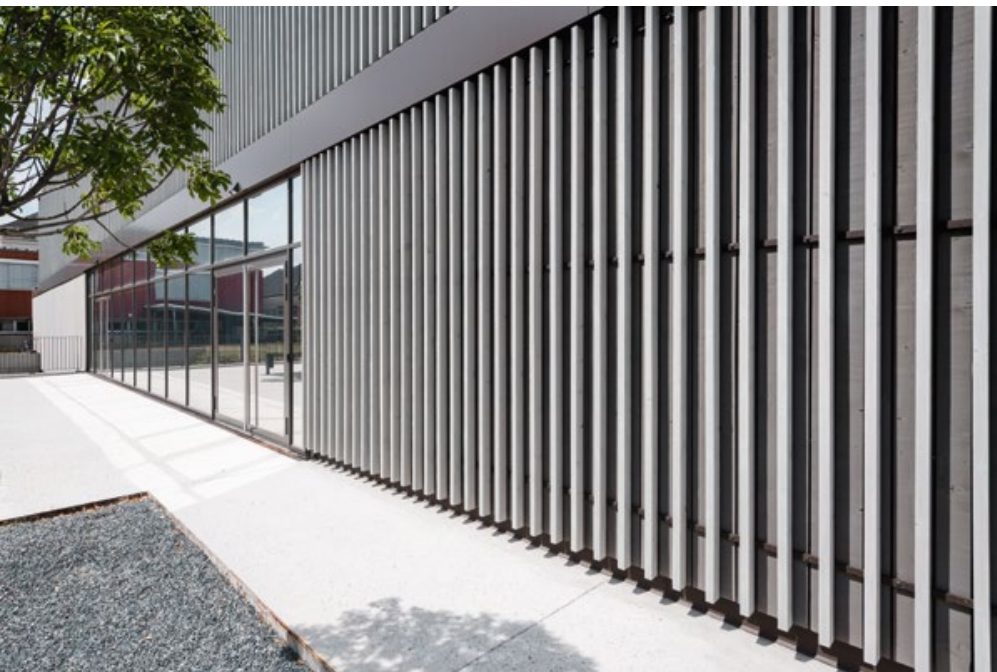

SECONDARY SCHOOL & MULTI-PURPOSE HALL
ZISTERSDORF, AUSTRIA
CLIENT: MUNICIPALITY OF ZISTERSDORF
ARCHITECTURE: POPPE*PREHAL ARCHITEKTEN
FROM MAREINER: GRAN PARADISO 212°
PHOTOGRAPHY: KATARINA PASHKOVSKAYA





HOTEL RESTAURANT CAFÉ KRAINER, AUSTRIA
CLIENT: ANDREAS KRAINER
ARCHITECTURE: VIERECK ARCHITEKTEN
FROM MAREINER: WÖRTHERSEE, VULCANO
PHOTOGRAPHY: TONI MUHR

**REFUGE IN THE VINEYARDS,
AUSTRIA**
FROM MAREINER:
GRAN PARADISO 212°
PHOTOGRAPHY: TONI MUHR





MOUNTAIN CABLE CAR STATION PLANAI SCHLADMING, AUSTRIA

CLIENT: PLANAI-HOCHWURZEN-BAHNEN GMBH

ARCHITECTURE: KREINER ARCHITEKTUR ZT GMBH

FROM MAREINER: GRAN PARADISO 212°

PHOTOGRAPHY: HARALD STEINER





ALMWELT REITERALM, AUSTRIA
FROM MAREINER: GRAN PARADISO 212°, MARMOLADA
PHOTOGRAPHY: CHRISTINE HÖFLEHNER

SAUNA & SPA



SAUNA & SPA

It's like eating: If the ambience is right, the enjoyment is even greater. And it's not just the eye that takes part in the sauna, but all other senses, too, that make the choice of selected, beautiful woods even more important. Be it a chalet, hotel, fitness studio or personal comfort zone – with panels from Mareiner you create an ambience of pure naturalness with the best of fire, water and forest.

THE SAUNA GOERS FROM MAREINER

- Gran Paradiso 190°
- Gran Paradiso 212°
- Mont Blanc 212°
- Großglockner
- Matterhorn
- Marmolada
- Piz Nair
- Piz Lagrev
- Piz Palü
- Zermatt Gris
- Zermatt Miel
- Wengen
- Gstaad
- Crans Montana

A SLIM MATTER

Physics wants wood to expand in steam. To make sure there is enough room for maneuver in the sauna, we always supply you with the panels of your choice in the narrowest dimension.

ORIGINAL HAND-PICKED - THE SAUNA WITH RECLAIMED WOOD

If you decide on a sauna interior made from original reclaimed wood, we will be happy to put together a special selection without pine wood for you upon request.

LAYERED STRUCTURE - THE SAUNA WITH DESIGN PANELS

Like an extension, the sauna is made with our multi-layered design panels. All you need is one thing: Our special gluing that is suitable for saunas.



A HOT TIP FROM US

Thermally-treated wood particularly retains its dimensions. We therefore also recommend using boards and panels that are ideally prepared for steam and heat when building a sauna. You can find out precisely how and why on page 10.



ALMWELT REITERALM, AUSTRIA
ARCHITECTURE: SCHWAB-WALCHER GMBH
FROM MAREINER: GRAN PARADISO 212°, MARMOLADA
PHOTOGRAPHY: CHRISTINE HÖFLEHNER





PRIVATE HOUSE M., STYRIA
ARCHITECTURE: STEFAN MADEREBNER
FROM MAREINER: MARMOLADA LAVA, GRAN PARADISO
212°, PIZ BUIN, GARDASEE
PHOTOGRAPHY: TONI MUHR

OUTDOOR SAUNA J., STYRIA
FROM MAREINER: GROSSGLOCKNER, MARMOLADA VECCHIA,
MONT BLANC, GARDASEE
PHOTOGRAPHY: KATARINA PASHKOVSKAYA

PRIVATE HOUSE R., AUSTRIA
FROM MAREINER: PIZ BERNINA
PHOTOGRAPHY: TRIXL.TIROL



DOORS



DOORS

Our wood design opens the doors between two spaces widely to beauty, durability and functionality. Come closer, come in!

HOW SHOULD WE DO IT?

Brushed? Hacked? Or original after all? Maybe it can also be reclaimed wood? We have the variety, you have the choice: From our complete range of wall panels. Because every single variant has what it takes to become your door.

VERSIONS

1- or 2-leaf, with or without glass cut:

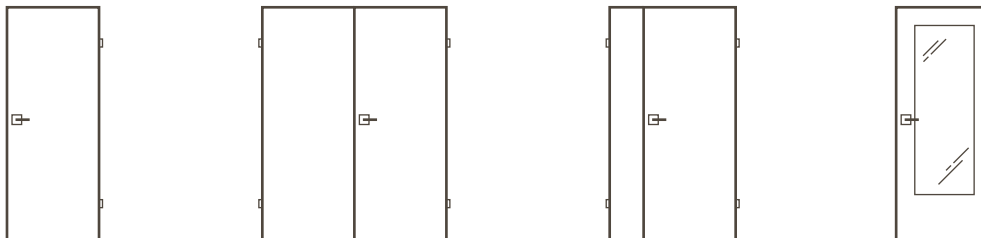

CONSTRUCTION OF A DOOR

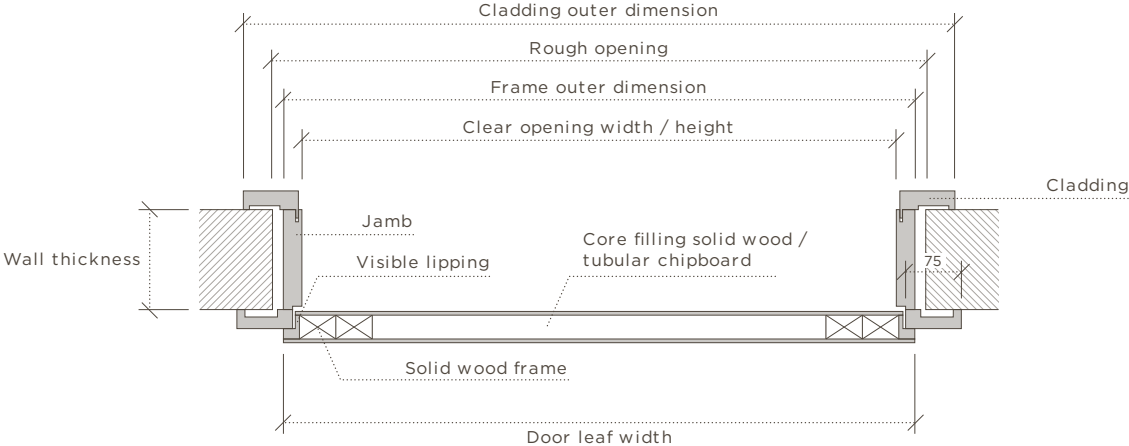

DIMENSIONS OF A DOOR

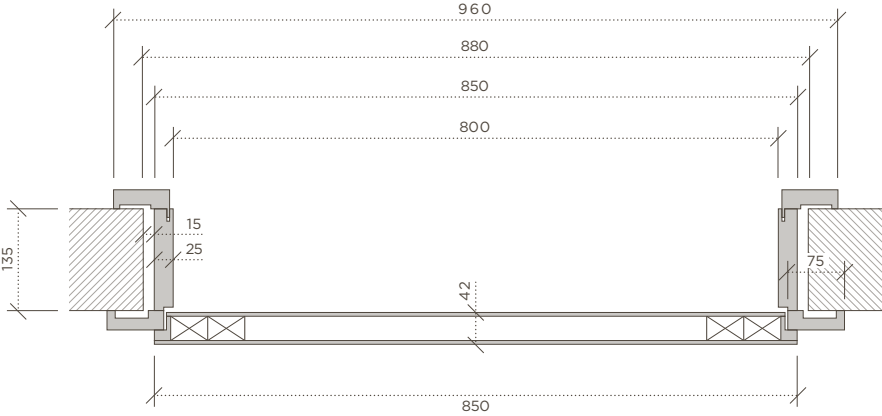

OUR CONSTRUCTION VARIATIONS OPEN ALL DOORS AND GATES

BLANK DOOR LEAF

- without rebate milling, lock and hinge holes
- solid wood or tubular chipboard core filling
- on request with visible lipping or edge band in surface quality

Lipping

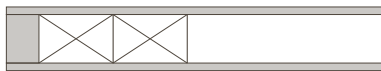

Edge strip (sliding doors)



DOOR LEAF

- including rebate milling, lock and hinge drillings
- solid wood or tubular chipboard core filling
- including lock and door hinges, excluding door handles

Rebated doors

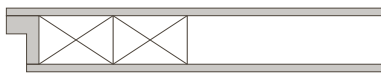

Unrebated / flush doors

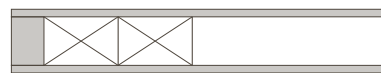

DOOR ELEMENT

- door leaf + jamb
- ready assembled element including lock and door hinges, excluding door handles (door handles can be supplied upon request)

Wrap-around frame:
Jamb for rebated doors

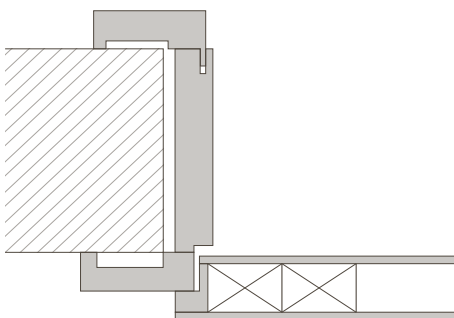

Jamb for flush doors

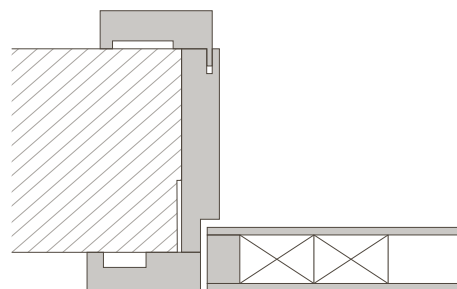

Block jamb:

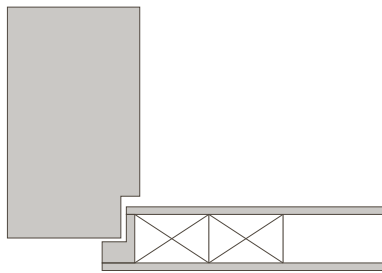

TECHNICAL DETAILS

SLAT DIRECTION OPTIONS	vertical or horizontal
LIPPING / EDGE STRIP	in surface quality; for door blanks also possible in natural spruce
MODEL OPTIONS	<ul style="list-style-type: none">• 1-wing• 2-wing• with glass element• without glass element
DESIGN OF THE DOOR LEAF	<ul style="list-style-type: none">• rebated 14/24 mm• flush• blank• sliding element
DOORSTOP	left or right possible
DOOR FITTINGS	available in stainless steel or matt black
LOCK TYPES	<ul style="list-style-type: none">• with key• as a rotary knob or• with a cylinder lock
USE	CE Type 4 / indoor use
BONDING	melamine-urea / dispersion adhesive
COATING	natural or oiled
WEIGHT	approx. 31 kg, varies depending on the type
DOOR HINGES	<ul style="list-style-type: none">• rebate arrangement: 2- to 3-part hinges with 16 mm• Tectus hinges for flush variants• number of door hinges depends on size and weight of the door leaf

TO THE MILLIMETER

DOOR LEAF DIMENSIONS

WIDTH IN MM	HEIGHT IN MM	THICKNESS IN MM
650	2030	42
700	2030	42
750	2030	42
800	2030	42
850	2030	42
900	2030	42
950	2030	42
1050	2030	42

Special widths and heights can be manufactured upon request.

JAMB DIMENSIONS

(Clear opening width/ Clear opening height)

WIDTH IN MM	HEIGHT IN MM	WALL THICKNESS
600	2010	from 90 to 180 mm
650	2010	from 90 to 180 mm
2010	2010	from 90 to 180 mm
700	2010	from 90 to 180 mm
750	2010	from 90 to 180 mm
800	2010	from 90 to 180 mm
850	2010	from 90 to 180 mm
900	2010	from 90 to 180 mm
1000	2010	from 90 to 180 mm

On request, special widths and heights can also be manufactured here.

DOOR LEAF CONSTRUCTION



DECORATIVE COVER SIDE*

CORE FILLING SOLID WOOD /
TUBULAR CHIPBOARD

DECORATIVE BACKSIDE*

* DEPENDING ON THE DESIRED PRODUCT

JAMB



DEPENDING ON THE DESIRED PRODUCT

DOOR ELEMENT

- door leaf + jamb
- including lock and door hinges
- door handles upon request





CHALET F, LAPLAND
ARCHITECTURE: FINNCOLLECTION
FROM MAREINER: GRAN PARADISO 190°
PHOTOGRAPHY: ROMAIN FAVELIER



PARADIS DU PRALONG, COURCHEVEL, FRANCE
CLIENT: STEFFEN GRUSCHKA
FROM MAREINER: ZERMATT GRIS
PHOTOGRAPHY: VALLAT COURCHEVEL 1850



PRIVATE HOUSE H., VORARLBERG, AUSTRIA
INTERIOR DESIGN: STEFAN SCHWEIGHOFER
FROM MAREINER: PIZ BUIN
PHOTOGRAPHY: MARCEL HAGEN. STUDIO22.AT



PRIVATE HOUSE R., AUSTRIA
ARCHITECTURE: TRIXL GMBH & CO. KG
FROM MAREINER: PIZ BERNINA
PHOTOGRAPHY: TRIXL.TIROL



PRIVATE HOUSE PANORAMA, AUSTRIA
FROM MAREINER: SIMPLON, CRANS MONTANA
PHOTOGRAPHY: MAXIMILIAN HAIDACHER

FURNITURE



FURNITURE

Many captivatingly beautiful pieces of furniture have been created from Mareiner design panels, all of which impress with more than just their appearance: Our three-layer panels are made for a long life under daily wear and tear. No matter whether it is kitchen fronts or sideboards. Or, for that matter, tables, wardrobes, shelving systems or even complete hotel room furnishings.



SERVICE WITH AN EDGE

- Which Mareiner design panel you use for your project is purely a matter of taste. They are all 100% suitable for furniture and furnishing construction.
- We would be happy to make the cuts you need. Of course, also based on your piece list.
- At your request, we cover each panel with a 3-mm-thick solid wood edge in the design of the surface – for a perfect appearance.
- In consultation with you, we prepare the holes for fittings from all well-known manufacturers ex works.



PRIVATE HOUSE D., AUSTRIA
ARCHITECTURE: MARION WICHER, WOW ARCHITECTURE
FROM MAREINER: DAVOS, SIMPLON
PHOTOGRAPHY: TONI MUHR



**PRIVATE HOUSE PANORAMA,
 STYRIA, AUSTRIA**
ARCHITECTURE: MARION
 WICHER, WOW ARCHITECTURE
FROM MAREINER:
 SIMPLON, CRANS MONTANA,
 WÖRTHERSEE
PHOTOGRAPHY: MAXIMILIAN
 HAIDACHER





MAREINER OFFICE, STYRIA, AUSTRIA

CLIENT: MAREINER HOLZ GMBH

ARCHITECTURE: MARION WICHER,
WOW ARCHITECTEKTUR

FROM MAREINER: JUNGFRAU

PHOTOGRAPHY: TONI MUHR

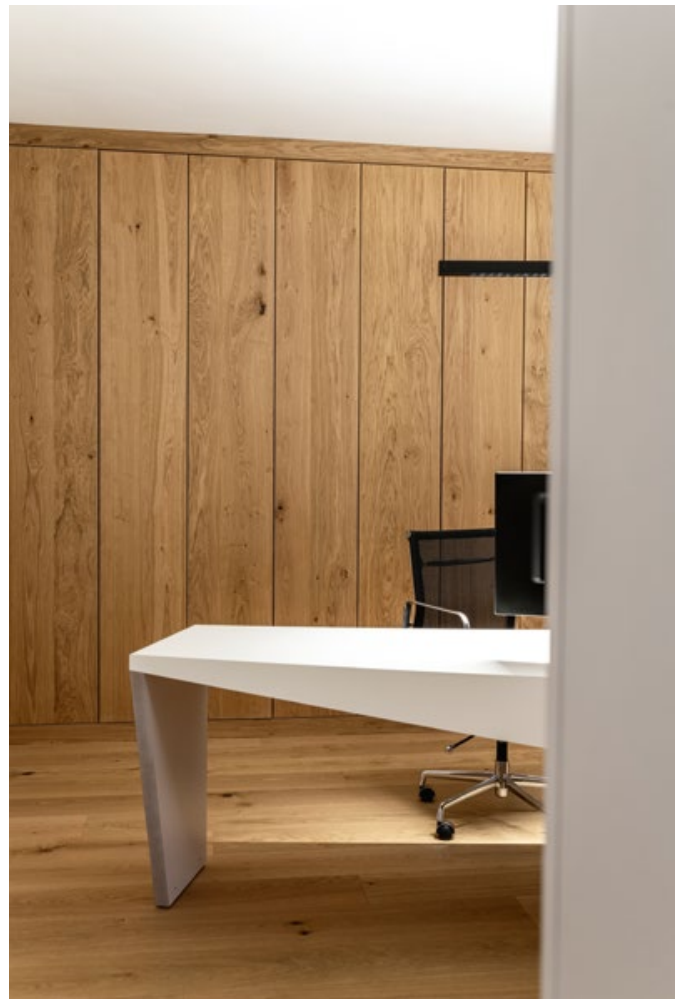





PARADIS DU PRALONG, COURCHEVEL, FRANCE
CLIENT: STEFFEN GRUSCHKA
FROM MAREINER: ZERMATT GRIS
PHOTOGRAPHY: VALLAT COURCHEVEL 1850





PRIVATE HOUSE G., AUSTRIA
CLIENT: GLOGER FAMILY
ARCHITECTURE: HOLZARCHITEKTEN ZT KG
FROM MAREINER: PIZ BERNINA LAVA
PHOTOGRAPHY: TONI MUHR

ALM WELLNESS HOTEL PIERER, AUSTRIA
CLIENT: PIERER FAMILY
ARCHITECTURE: JOSEF GÖBEL GMBH
FROM MAREINER: ZUGSPITZE
PHOTOGRAPHY: HARALD EISENBERGER





THE MAREINER
ARCHITECTURE SERVICE



MAREINER FOR ARCHITECTS

You can build with us. Just like you can rely on us – as a natural ally of all architects. We feel close to you because we face similar challenges – finding the best solution for every task. Not just in terms of design, but also technically and economically. The Mareiner Architecture Service is the place where we find, develop and perfect the ideal variant together.

FINDING THE SOLUTION TOGETHER



DEAR MS. SAMPLE
DEAR MR. SAMPLE!

- We definitely pride ourselves on our product photography: Standing behind them are outstanding professionals in their field. Nevertheless, a single real sample tells more than a thousand pictures, no matter how good they are.
- Do not hesitate to order samples of the products you are seriously interested in from us.
- Our hand samples are 30 x 20 cm in size. Three of them fit into one package.
- Speaking of which: We ship throughout Europe.

If you want to order now:
The QR code takes you directly there.



WE'RE HAPPY TO DO THIS FOR YOU

As specialists in wood design solutions, we are happy to provide samples that are as individual as our developments and results. Simply contact your Mareiner wood designer and a new order will be sent to our sample workshop.

MAREINER WOOD CINEMA

Drinks from the coffee bar and the refrigerator are provided, as well as comfortable seating: Take a seat in our spacious showroom in Sankt Marein and experience our portfolio in all its fullness and size in our deluxe showroom. With your sense of sight, smell and touch, the best advice and close contact with the manufacturer.

THE WORLD OF BOARDS IN SANKT MAREIN

- AROUND 500 M² OF BOARD EXPERIENCE WITH
- OVER 100 SAMPLES OF ALL WOOD AND FINISHING VARIANTS PLUS
- 50 DESIGN SOLUTIONS IN XXL VIEW



ON TO THE INSPECTION

In the Mareiner Wood Cinema there is sample upon sample of all of our regular panels and design panels. In the course of developing an individual solution for you, we provide you with individual samples. That's clear as day.





**DO YOU HAVE SOMETHING IN MIND ALREADY?
LET'S GO TO THE MAREINER WOOD CINEMA!**

**BOOK YOUR TICKET NOW AT:
HOLZKINO@MAREINER.COM OR VISIT US
ON OUR WEBSITE:**







NOTE

Wood is a natural product.
Printing may lead to slight differences
in the shape, color and grain of the wood
used and printed.

Subject to changes, typesetting and printing errors.

STATUS: SPRING 2024

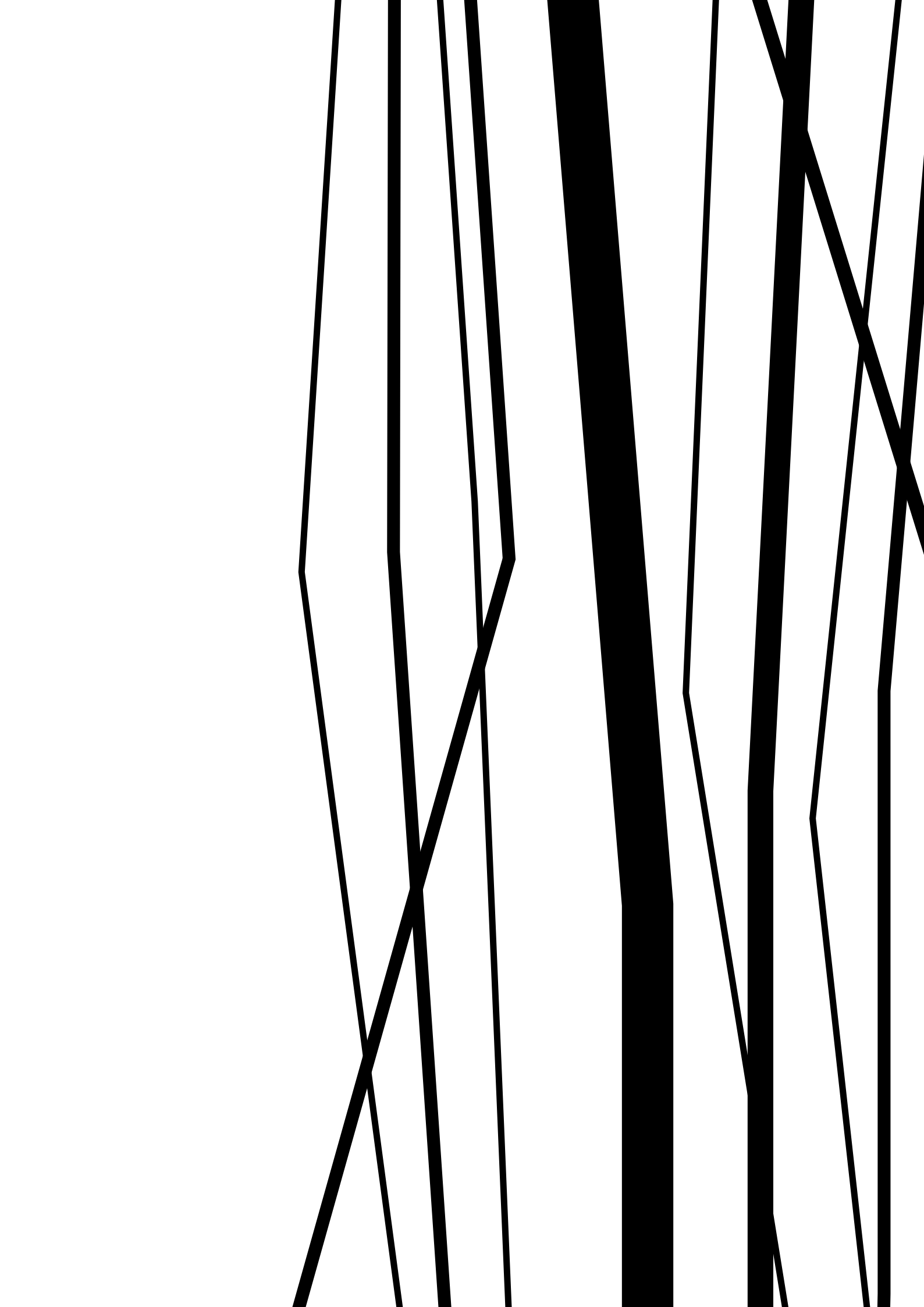



MAREINER

MAREINER HOLZ GMBH

Mattnerstraße 8
8641 St. Marein im Müürztal
Austria

+43 (0) 3864/4650-0
office@mareiner.com

MAREINER ALTHOLZ GMBH

Kremsstraße 16
4553 Schlierbach
Austria

+43 (0) 7582/816 54
altholz@mareiner.com

MAREINER HOLZ S.R.O

Žilinská 790
017 01 Považská Bystrica
Slovakia

+421 907 595 576
office@mareiner.com

WWW.MAREINER.COM